

VK4105G2000 SERIES

GAS CONTROLS FOR COMBINED VALVE AND BOILER CONTROL MODULATING SYSTEM WITH LOAD CONTROL (CVBC-LoCon)

PRODUCT HANDBOOK

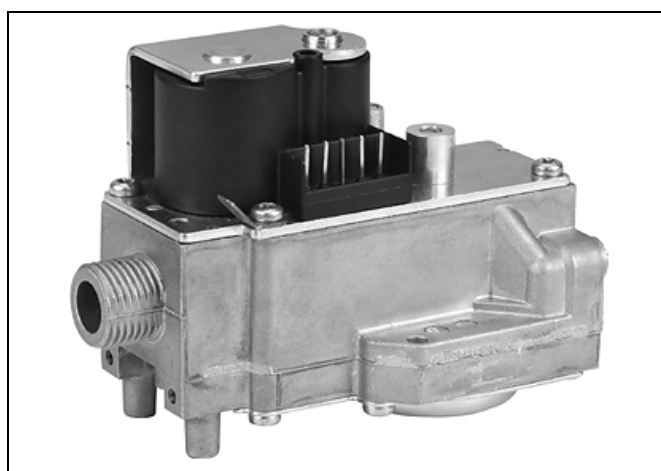

APPLICATION

The VK4105G2000 Series gas control and S49.. series boiler control have been specially developed for application in gas fired appliances with direct burner ignition that require electric modulating control of the gas input like instantaneous hot water combi boilers and air heating appliances. (CVBC-LoCon)

The system is based on a combustion feedback of flame current (load control) on atmospheric burners.

For this system, the VK4105G2000 series gas control has been designed to have a S49.. series boiler control attached directly onto the valve or it can be connected to the separate S4962 bare board boiler control.

The combined system then provides programmed safe light up, flame supervision, regulation and modulation of the gas flow to the main burner and control of the main functions of the appliance.

Contents

General	Page
Description	2
Features	3
Dimensional drawing	4
Gas control	
Specifications	5
Installation	7
Electrical connection	10
Adjustments, final checkout and maintenance	11
Construction and working principles	12
Boiler power control	13
Various	
Quality assurance statement	14
Standards and approvals	14
Ordering information	15
Replacement parts and accessories	16

DESCRIPTION

The **CVBC-LoCon** system comprises a modulating gas control with on/off regulating and modulating function based on combustion feedback of the flame-current (LoCon) and a boiler-control with integrated power supply for the electric modulating operator.

In this system the flame-current is proportional to the boiler load. The flame-current is the controlled parameter rather than the valve-current. Improved temperature-control and automatic self-adjustment (adaptive control) can be achieved because of this.

The control system

The Combined Valve Boiler Control modulating system (CVBC-LoCon) controls and performs all the functions required for safe ignition, flame supervision, for safely regulating the gas flow to the main burner and control of the main functions of the appliance.

The construction of the VK4105G2000 series valve is optimized and dedicated to function in combination with the S49.. series boiler control.

The VK4105G2000 Series gas control comprises a standard body to which a range of features can be factory included to give various functional options. These functional options include: servo pressure regulation, modulating control to fulfil a range of control applications.

The VK4105G2000 Series gas control has a first direct on/off operator for opening the safety valve of class B according to EN 161 and a second electric on/off servo operator for control of the main valve of class J according to EN 161 (for explanation class J, see chapter Standards and approvals page 16).

The second electric operator also includes the modulation function.

The minimum gas flow is automatically set dependent on the adjusted software parameter of the minimum boiler load.

The maximum gas flow is determined by a factory set throttle or an optional pressure-regulator.

The pressure regulator is in accordance with class B requirements of EN 88.

The VK4105G2000 Series can handle natural gas and LP gas.

General

All measurements are carried out under standard conditions listed below unless otherwise is indicated.

Standard conditions

- P_{inlet} 25 mbar nominal pressure, dry air of 20°C
- $P_{ambient}$ 1013 mbar
- $T_{ambient}$ 20°C
- Outlet orifice 4.3 mm
- Flow indication in m^3/h
- Recording of outlet pressure with a transducer connected to a $1/2"$ pipe with a length of 10 times the diameter with a short hose at 5 times the diameter.
- Nominal voltage
- 90° tilted, i.e. the position when the operators are lying horizontal.

FEATURES

General

- All burner control safety functions concentrated in one reliable and optimized system.
- Specially designed to provide the optimum system solution in gas appliances with a DBI to light the main burner.
- Improved temperature-control and automatic self-adjustment (adaptive control) of the appliance by the Load Control Control system.
- VK4105G2000 gas control incorporates time proven design concepts assuring reliability.
- ON/OFF control of main burner by an electric direct operator and electric servo operator directly energized from boiler (2 coils in total)
- Easy assembly of S4965-series ignition control on gas control by plugging it on from the top.
- Maximum gasflow setting by an integrated throttle or an optional pressure regulator.
- Minimum gasflow is automatically set dependent on the software parameter of the flame-current.

Gas control

- Closing force: B + J
- All adjustments are accessible from the top.
- 9 mm diameter pressure taps on top face for checking inlet and outlet pressure
- Two mounting holes for thread forming screws are at the bottom of the gas control for rigid attachment to the appliance.

Gas connection options

- Inlet \varnothing 18.6 mm and outlet \varnothing 18.6 mm are straight through and can receive flanges.
- Internal thread (ISO 7-1):
 - $\frac{3}{8}$ " inlet and $\frac{3}{8}$ " end outlet; body length 115 mm.
 - $\frac{1}{2}$ " inlet and $\frac{1}{2}$ " end outlet; body length 115 mm.
 - $\frac{1}{2}$ " NPT inlet and flanged end outlet; body length 115 mm.
- External thread :
 - $\frac{1}{2}$ " inlet and $\frac{1}{2}$ " end outlet; body length 135 mm
 - $\frac{1}{2}$ " inlet and standard flanged end outlet; body length 120 mm
 - $\frac{3}{4}$ " inlet and $\frac{3}{4}$ " end outlet; body length 135 mm
 - $\frac{3}{4}$ " inlet and standard flanged end outlet; body length 120 mm
 - $\frac{3}{4}$ " inlet and standard flanged side outlet; body length 120 mm
- The side outlet can only be connected to a flanged burner manifold.
- Pressure feedback fittings for 4 or 6 mm silicon tube can be mounted.

Electrical connection

- The appropriate S4965-series boiler-control can be connected to the valve by plugging it on.
- The S4962 series bare-board boiler-control is connected to the valve through wiring +connector

DIMENSIONAL DRAWING

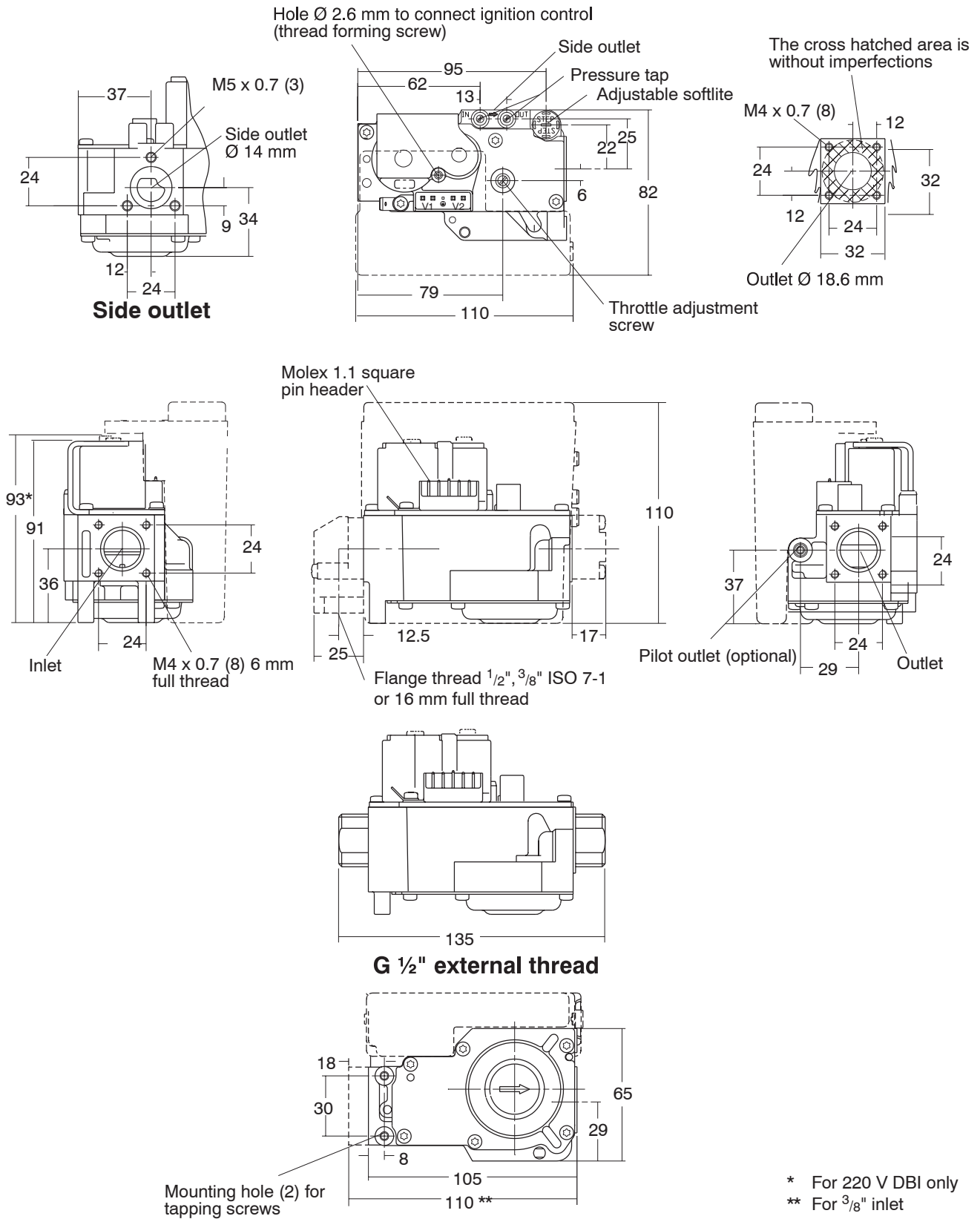

Please do not apply high forces to the metal dust-cap on the second coil to avoid change of valve seat !

SPECIFICATIONS

Models

See model number chart on page 15

Main gas connection

- Standard see table 2. page 5
- Optional see table 3. page 6
- Side outlet can be fitted direct to a flanged burner manifold.

Inlet and outlet with $\frac{3}{8}$ " or $\frac{1}{2}$ " ISO 7-1 internal pipe thread and straight or elbow flanges with $\frac{3}{8}$ " or $\frac{1}{2}$ " ISO 7-1 internal pipe thread are according to the torsion and bending stress of EN126 group 2

Connections with G $\frac{1}{2}$ " or G $\frac{3}{4}$ " external thread fitted with nuts according to ISO 228-1 in combination with applicable sealing(s) withstand the torsion and bending stress of EN 126 group 1

Ambient temperature

-15 ... 60°C with plug-on S4965 (CVBC)
-15 ... 70°C

Humidity

95% RH max. at 40°C

Storage

- 30 ... 70°C

Pressure feedback connection

The servo pressure regulator has an M5 thread connection for pressure feedback on maximum pressure setting.

Dimensions

See dimensional drawing on page 4 and page 5

Minimum regulation capacity

0.3 m³/hr air (at 2 mbar outlet pressure with 2.8 mm outlet orifice)

Outlet pressure range

Natural Gas/LP: 1.5 ... 32 mbar

Maximum outlet pressure setpoint

Conditions for devices for which a setting for the throttle is specified on the O.S. card, the outlet pressure set point shall deviate no more than $\pm 4\%$ (max. 1 mbar) from this adjusted set point pressure, when tested at the test inlet pressure as stated on the O.S. card

Minimum rate range

Software adjustable on S49.. series boiler control

Maximum inlet pressure

60 mbar

Main valve opening characteristics (measured with gas)

Under conditions where the supply pressure is at least 2.5 mbar above the outlet pressure setting, the dead time shall be 1 s maximum.
Full outlet pressure will be reached within 2 s from start of flow.

Valve closing characteristics

The VK4105G2000-series will close within 1 second from operator de-energization, (at an inlet pressure of 22.5 mbar and minimal 2.5 mbar pressure drop).

Electrical data

Power consumption: see table 1.

Max modulation current at nominal voltage: 30 mA

Operable voltage range: the gas control will function satisfactory between 85% and

110% of the rated voltage on the S49..series boiler control, see tabel 4.

Valve classification

1st valve: class B, 50 mbar backpressure

2nd valve: class J, 0 mbar backpressure

Maximum operating pressure

The P_{max} = 60 mbar indication on the housing of the gas control is the maximum pressure at which it functions safely.

Mounting position

90° tilted (i.e. with coils horizontal) in any direction from the upright, deviation $\pm 5^\circ$ max.

NOTE: Upright position is not applicable

Mounting holes

Two mounting holes for thread forming M4 screws are located on the bottom of the gas control.

For versions with external thread there are two additional mounting holes for thread forming screws at the inlet side of the gas control.

The four holes at inlet and outlet for mounting a flange on the gas control are provided with M4 thread with a minimum of 6 mm full thread.

In case of side outlet the three holes for mounting the flange are provided with M5 thread with a minimum of 6 mm full thread.

Table 1: Power consumption (W)

Power consumption 1 st + 2 nd operator			
Nominal voltage to S49.. 230 V, 50 Hz		110% nominal voltage to S49.. 253 V, 50 Hz	
VA	W	VA	W
7.2	8.7	7.9	9.6

Table 2: Standard valve connection

Inlet	End outlet	Side outlet	Body length (mm)
Flanged	Flanged	--	105
Flanged	--	Flanged	105
Internal $\frac{3}{8}$ " ISO 7-1	--	Flanged	115
Internal $\frac{1}{2}$ " ISO 7-1	--	Flanged	115
Internal $\frac{1}{2}$ " ISO 7-1	Internal $\frac{1}{2}$ " ISO 7-1	--	115
Internal $\frac{1}{2}$ " NPT	Internal $\frac{1}{2}$ " NPT	--	115

Table 3: External valve connection (optional)

Inlet	End outlet	Side outlet	Body length (mm)
G 1/2"	G 1/2"	--	135
G 1/2"	Flanged	--	120
G 3/4"	G 3/4"	--	135
G 3/4"	Flanged	--	120
G 3/4"	--	Flanged	120

Maximum allowable leakage

Each gas control is factory tested to meet the following leakage requirements:

- outerwall: 50 cm³/h at test pressure of 150 mbar.
- safety valve: 40 cm³/h at test pressure of 6 and 150 mbar.
- main valve (plus operator inlet valve): 40 cm³/h at test pressure of 6 and 150 mbar.

High pressure test

In the "OFF" condition, the gas control will withstand 3 bar (air) inlet pressure without damage. Attempts to operate the gas control, while in this fault condition will not damage it.

Operable voltage range

The gas control will function satisfactory between 85% and 110% of the rated voltage on S49..

Table 4: Operable voltage range

Rated voltage	Operable voltage
230 V, 50 Hz	196 ... 253 V

Oscillation

The difference between maximum and minimum outlet pressure must be equal or less than 0.5 mbar.

Test conditions:

- maximum inlet pressure in accordance with regulator range.
- outlet orifice 2.8 dia (this means 0.3 m³/h air at 2 mbar outlet pressure)
- recording of outlet pressure with a transducer connected to a 1/2" pipe with a length of 10 d. with a short hose at 5 d.
- attenuation X-Y recorder must be switched on zero.
- other pressure gauges or flow meters must be disconnected.
- Ambient temperature 20°C

Tap sensitivity of outlet pressure

For all gases the maximum deviation may be 1 mbar or 10% whichever is the greatest.

Repeatability of outlet pressure

For all gases the maximum deviation from set point is: ± 0.5 mbar or $\pm 3\%$ of the set point value, whichever is the greatest.

Total set point shift**Table 5: Total set point shift**

Pressure range (mbar)	Tolerance
1.5 ... 32	6% of the set point value or 1 mbar whichever is the greatest

Design life

500.000 cycles for safety and main valve operator.
Cycle frequency maximum 100 cycles /hour.

INSTALLATION

IMPORTANT

Take care that installer is a trained experienced service person.

Turn off gas supply before starting installation.

Disconnect power supply to prevent electrical shock and/or equipment damage.

Do not remove seals over inlet and outlet until the device is ready to be installed.

Take care that dirt cannot enter the gas control during handling.

Mounting position

90° tilted (i.e. with coils horizontal) in any direction from the upright, deviation ±5° max.

NOTE: Upright position is not applicable

Main gas connection

Gas controls with internal thread

- Take care that dirt cannot enter the gas control during handling.
- Use a sound taper fitting with thread according to ISO 7-1 or a piece of new, properly reamed pipe, free from swarf.
- Do not thread or tighten the pipe or pipe fitting too far (see table below). Otherwise distortion and malfunction could result.

Pipe size (inch)	Max. length of pipe thread (mm)
$\frac{3}{8}$	14
$\frac{1}{2}$	18.6

- Apply a moderate amount of good quality thread compound to the pipe or fitting only, leaving the two end threads bare. PTFE tape may be used as an alternative.
- Tighten gas control using the right open end wrench. See fig. 3.

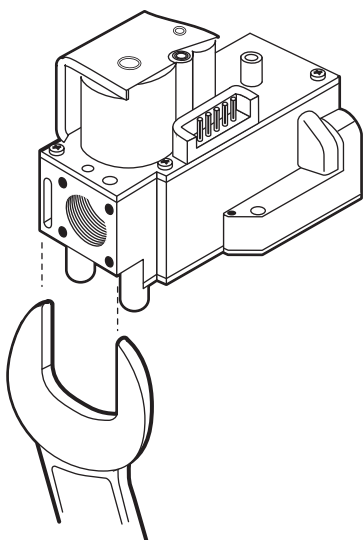

Fig. 1.

- Ensure the gas flows in the same direction as the arrow on the bottom of the gas control.

Gas controls for flange connection

- Insert "O"-ring in the groove of each flange. If necessary grease "O"-ring slightly to keep it in place.
- Mount gas control between flanges using the four screws for each flange.

Gas controls with external thread connection

IMPORTANT

Fastening torque flat sealing ring only applicable for type Klingersil C4324

Olives for this application are not supplied by Honeywell

Torque of olive applications may differ depending on olive dimensions.

① With $\frac{1}{2}$ " nut and flat sealing ring for pipe 14 mm (see fig. 2.)

Nut: order number:..... 45.006.583-005

Flat sealing ring according to DIN 3535-6 with size $\varnothing 18 \times \varnothing 12 \times 1.5$ mm

order number 45.006.582-002

Fastening torque: maximum 40 Nm
minimum 25 Nm

Pipe end construction: see fig. 5.

② With $\frac{1}{2}$ " nut and flat sealing ring for pipe 15 mm (see fig. 2.)

Nut: order number:..... 45.006.583-004

Flat sealing ring according to DIN 3535-6 with size $\varnothing 18 \times \varnothing 12 \times 1.5$ mm

order number 45.006.582-002

Fastening torque: maximum 40 Nm
minimum 25 Nm

Pipe end construction: see fig. 6.

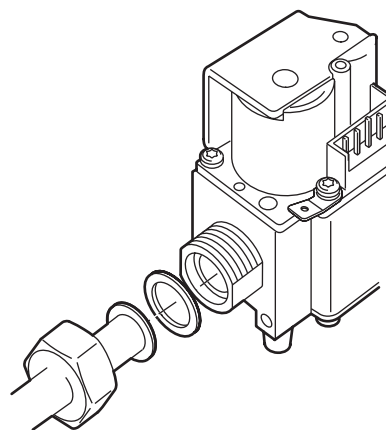

Fig. 2. External thread connection with nut and flat sealing ring

③ With $\frac{3}{4}$ " nut and olive (see fig. 3.)

Pipe diameter: 15 mm

Nut: order number:..... 45.006.583-003

Fastening torque: maximum 50 Nm
minimum 30 Nm

Pipe end construction: square off end of tubing and remove burrs.

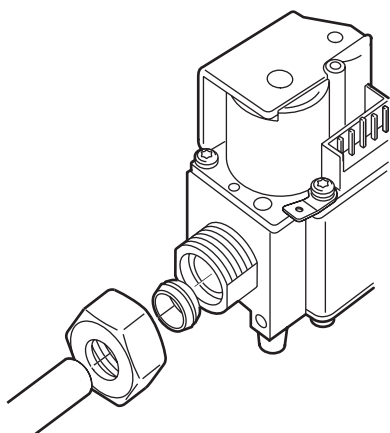

Fig. 3. External thread connection with nut and olive

④ With $\frac{3}{4}$ " nut and "O"-ring (see fig. 4.)

Pipe diameter: 15 mm

Nut: order number:..... 45.006.583-003

"O"-ring size: $\varnothing 14.3 \times \varnothing 2.4$ mm

order number 45.001.528-048

Fastening torque: maximum 50 Nm

minimum 10 Nm

Pipe end construction: see fig. 7.

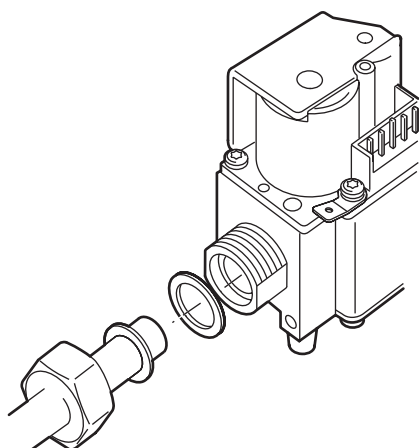

Fig. 4. External thread connection with nut and "O"-ring

⑤ With $\frac{3}{4}$ " nut and flat sealing ring for pipe 15 mm (see fig. 2.)

Nut: order number:..... 45.006.583-003

Flat sealing ring according to DIN 3535-6 with size $\varnothing 24 \times \varnothing 16 \times 1.5$ mm:

order number 45.006.582-001

Fastening torque: maximum 50 Nm

minimum 30 Nm

Pipe end construction: see fig. 8.

⑥ With $\frac{3}{4}$ " nut and flat sealing ring for pipe 18 mm (see fig. 2.)

Nut: order number:..... 45.006.583-002

Flat sealing ring according to DIN 3535-6 with size $\varnothing 24 \times \varnothing 16 \times 1.5$ mm

order number..... 45.006.582-001

Fastening torque: maximum 50 Nm

minimum 30 Nm

Pipe end construction: see fig. 9.

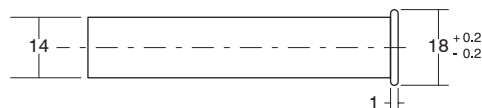

Fig. 5. Pipe (dia 14 mm) for flat sealing ring connection

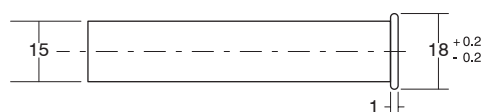

Fig. 6. Pipe (dia 15 mm) for flat sealing ring connection

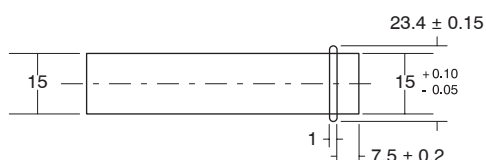

Fig. 7. Pipe end for "O"-ring connection

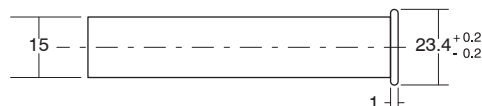

Fig. 8. Pipe (dia 15 mm) for flat sealing ring connection

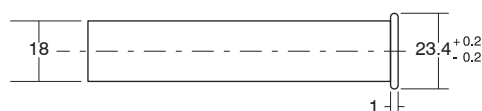

Fig. 9. Pipe (dia 18 mm) for flat sealing ring connection

Pressure feedback connection



WARNING

To avoid decreasing of performance of pressure regulator by pinching off the pressure feedback tubing, it is recommended to use a tube material which will not kink.

Pilot gas connection (if applicable)

- Square off the end of tubing and remove burrs.
- Slip compression fitting over tubing.
- Insert tubing into gas control housing until it bottoms, slide fitting into place and turn finger tight.
- Use a wrench to tighten fitting about 1¹/₂ turn beyond finger tight to shear of the olive.

Do not use jointing compound.

Connect other end of tubing to pilot burner according to the manufacturer's instructions.



CAUTION

Do not bend tubing at gas control after compression fitting has been tightened, as this may result in gas leakage at the connection.

Perform gas leak test

WARNING

FIRE OR EXPLOSION HAZARD CAN CAUSE PROPERTY DAMAGE, SEVERE INJURY OR DEATH

Check for gas leaks with a rich soap and water solution any time work is done on a gas control.

Gas leak test

- Paint all pipe connections upstream of the gas control with a rich soap and water solution. Bubbles indicate a gas leak.
- If a gas leak is detected, tighten the pipe connection.
- Stand clear while lighting the main burner to prevent injury caused from hidden gas leaks, which could cause flashback in the appliance vestibule. Light the main burner.
- With the main burner in operation, paint all pipe joints (including adapters) and gas control inlet and outlet with with a rich soap and water solution an approved leak detection fluid.
- If another gas leak is detected, tighten adapter screws, joints and pipe connections.
- Replace the part if gas leak can not be stopped.



CAUTION

Keep soap and water solution away from electrical connections.

ELECTRICAL CONNECTION

IMPORTANT

Disconnect power supply to prevent electrical shock and/or equipment damage.

Wiring must be in accordance with local regulations.

The appliance manufacturer's instructions should always be followed when provided. If such instructions are not provided see the connection diagrams for typical systems.

Before installing or replacing any control check that type number is correct for the application.

Ensure combustion chamber is free of gas before start up.

Conduct a thorough check out when installation is completed.

Electrical connection details

See Product Handbook EN2R-9028

ADJUSTMENTS, FINAL CHECKOUT AND MAINTENANCE

Adjustment



WARNING

Adjustments must be made by qualified persons only. If the appliance manufacturer supplies checkout and/or service and maintenance instructions carefully follow them. If these instructions are not provided then use the procedure outlined below.

NOTE: For adjustment of additional electrical minimum setting and/or gas outlet pressure during ignition see appropriate Product Handbook of ignition control.

Pressure tap

The gas control is provided with a pressure tap of 9 mm outer diameter. at inlet and outlet side.

When checking the pressure undo the screw a half turn and slip tube over nipple.

Ensure that screw is retightened after making test.

Maximum outlet pressure adjustment (see page 4)

- Start-up appliance in order to have gas input to burner and make sure appliance is running at maximum heat demand.
 - Check gas input to the appliance using a clocking gas meter or alternatively a pressure gauge connected to the outlet pressure tap.
- ² Turn the flow adjustment screw with a screw driver **in clockwise direction to decrease** and turn anti-clockwise to increase the gasflow.

Setting of minimum rate

The minimum rate is automatically set dependent on the software parameter of the boiler-control. For adjustment of the parameter see appropriate Product Handbook of boiler-control S496x.

Final checkout

After installation and any adjustment start the appliance and observe a complete cycle to ensure that all burner components function correctly.

Maintenance and service

Under normal circumstances no maintenance or service is required.

Screws on the valve that have been sealed must never be removed.

CONSTRUCTION AND WORKING PRINCIPLES

The VK4105G2000 gas control contains a first direct electric ON/OFF safety valve (A) and a second ON/OFF and modulating servo operated main valve (B). The modulating valve maximum output pressure can be adjusted by a throttle adjustment screw (C).

Description of the direct electric operator

The direct electric operator (RAC) is built up with a valve seat that is machined in the die cast body (E), the coil plate assy that forms the upper part of the product (F) and the plunger assy as moving part (G).

A sleeve (H) guides the plunger assy (G) and is assembled between body and coil plate assy. If the solenoid is energized the plunger is pulled-in and moves upwards. So the safety valve, which is directly attached to this plunger, is opened. The impact of the plunger on the stop is damped by a rubber silencer in the plunger.

Description of the servo operated modulating main valve

The main valve (B) is a spring closed and diaphragm (J) actuated valve located in the main gas passageway between the direct operated safety valve and the outlet of the gas control.

The main valve is opened by the servo systems "working gas" acting against the main valve diaphragm (J). So the position of

the main valve (B) is controlled by the "working gas" pressure in the servo system.

The "working gas" is obtained from the main gas stream through the servo valve (K) and a supply orifice.

The servo valve is located parallel to the main valve and is operated by the 2nd coil (M). This 2nd coil also operates the integrated modulation function by loading an integrated regulator diaphragm (N) with the required force through applying the appropriate current (based on % PWM input) which is determined in the electronic circuit that is connected to the gas control.

When the 2nd coil is energized at heat demand the pressure of "working gas" in the servo system is being built up. At a certain point this pressure opens the main valve (B) and the outlet pressure rises. Now the main valve is modulating and the outlet pressure is controlled by the balance between generated force on the plunger and outlet pressure through the regulator diaphragm. The higher the force becomes, the higher the outlet pressure will be and vice versa.

The outlet pressure can be limited to a maximum value by setting of the maximum servo pressure regulator (C). When the 2nd coil (M) is de-energized, the servo valve closes and the supply of "working gas" is shutt off. The load of the regulator diaphragm is released, the "working gas" can bleed to the outlet and the main valve closes.

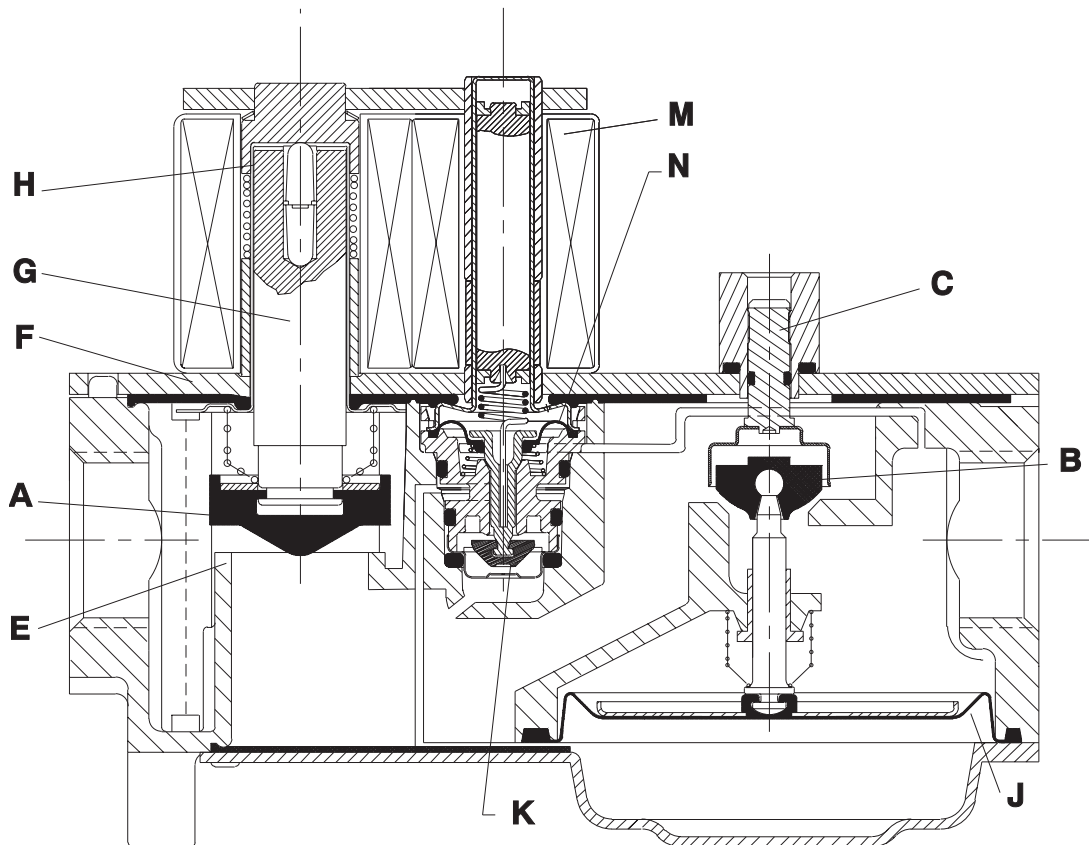

Fig. 10. Working principle

LOAD CONTROL

In the application the shape and position of the flame-rod and the flame-circuitry are adapted in such a way that the flame-current is proportional to the boiler load. In the CVBC-LoCon-system the flame-current is the controlled parameter rather than the valve-current.

At the first ignition after reset (installation or maintenance) the valve is opened at a default valve-current which assures lighting of the burner. After that the valve is modulated to the desired ignition boiler load (adjustable software parameter) and the ignition valve current is learned. Next starts will be done at the learned valve-current which assures smooth ignition of the burner.

At low watertemperature the requested flame-current will be high, the valve will open and the outletpressure increases. The maximum outlepressure and boiler load is limited by the gasvalve throttle.

When the watertemperature approaches the setpoint the valve will close which decreases the outletpressure. The minimum outletpressure and boiler load are determined by the minimum flame-current (adjustable software parameter).

When the heat-demand is finished, the valve closes and the burner is switched off.

QUALITY ASSURANCE STATEMENT

Products are manufactured under an ISO 9001 (1994) based and certified Quality System.

The quality system is described in the Honeywell Combustion Controls Center Quality Assurance Programme and its related operational procedures and instructions.

The quality system is approved by Gastec against certificate number 9.302/2.

The quality organisation is responsible for defining, maintaining, improving and verification of the quality systems in the field of design, production process and field quality service.

Assembly processes are guided by work instructions. Patrol inspections form part of the assembly processes.

At the end of the assembly phase, **all** gas controls are leakage and performance tested/adjusted.

Assembly inspection is performed by employees of the quality control department, using their own authorised equipment.

All inspections (incoming and assembly) are performed by trained personnel and according inspection procedures.

STANDARDS AND APPROVALS

Standards:

The VK4105G2000 series has been designed to meet the European Standards:

EN 88: Pressure governors

EN 126: Multifunctional controls.

EN 161: Automatic shut off valves

The safety shut off valve meets **class B** requirements.

The servo operated main valve meets **class J** requirements.

A class J valve as mentioned in EN 161; 1997 is equal or better than a class D' valve as mentioned in EN 297 and EN 483 and class D valves as mentioned in other standards.

According to bending stresses the gas control meets the highest requirements (group 2).

The pressure governor meets class B performance.

Regarding electric safety, the gas control can be used in appliances according to European Standard for household electrical requirements EN 60335 series.

The gas control also meets all Electro Magnetic Compatibility standards for non-industrial appliances.

Approvals

The gas control conforms with the following EC - Directives:

- Gas Appliance Directive (90/396/EEC)
- Low Voltage Directive (73/23/EEC)
- Electro Magnetic Compatibility Directive (89/336/EEC)

The fact that the gas control is certified to European Standard EN 88 EN 126 and EN161 means that the gas control meets the requirements in all EC and EFTA countries.

Details per O.S. number can be found in the Approvals List.

The registration number specific for each O.S. number is mentioned on the label of the control.

ORDERING INFORMATION

When ordering specify:

- Model number of CVI gas control component required: see model number chart below.
- The correct pilot burner for the installation concerned: refer to Honeywell ignition products guide EN0R-0038.

- NOTE: Complete gas control, replacement parts and accessories will be available under "TRADELINE" label. Ask your wholesaler for details.
- NOTE: An up-to-date product survey, with details of all new and existing products in these series, is available. Contact your local Honeywell sales representative for more information.

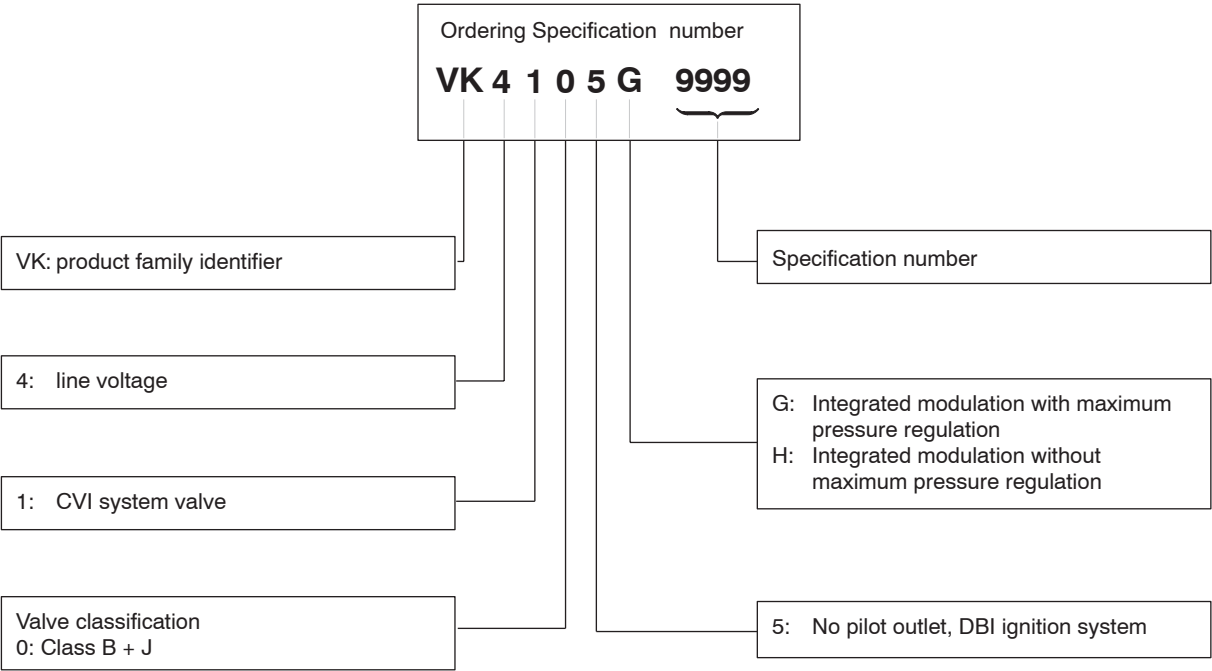

Fig. 11. Model number chart VK4105G

REPLACEMENT PARTS AND ACCESSORIES

Flange assemblies

Connection size	Configuration		"O"-ring	Screws	Packing quantity (pcs)	Order number
	Straight	Elbow				
3/8" BSP.PI	X	-	YES	YES	200	45.900.400-101
3/8" BSP.PI ¹⁾	-	X	YES	YES	200	45.900.400-103
3/8" BSP.PI ¹⁾	-	X	YES	NO	200	45.900.400-129
3/8" BSP.PI ²⁾	-	X	YES	YES	200	45.900.400-128
1/2" BSP.PI	X	-	YES	YES	200	45.900.400-102
1/2" BSP.PI	X	-	NO	NO	200	45.900.400-106
1/2" BSP.PI	X	-	YES	NO	200	45.900.400-131
1/2" BSP.PI ¹⁾	-	X	YES	YES	200	45.900.400-104
1/2" BSP.PI ¹⁾	-	X	NO	NO	200	45.900.400-108
1/2" BSP.PI ¹⁾	-	X	YES	NO	200	45.900.400-130
1/2" NPT	X	-	YES	YES	200	45.900.400-122
1/2" NPT ¹⁾	-	X	YES	YES	200	45.900.400-132
Ø 18.4 mm	X	-	YES	YES	200	45.900.400-123

¹⁾ Not applicable for mounting over pilot outlet.

²⁾ Applicable for mounting in all directions.

Honeywell

**Home and Building Control
Combustion Control Center Europe**

Honeywell BV

Phileas Foggstraat 7

7821 AJ Emmen

The Netherlands

Tel.: +31 (-)591 695911

Fax: +31 (-) 591 695200

<http://europe.hbc.honeywell.com>